

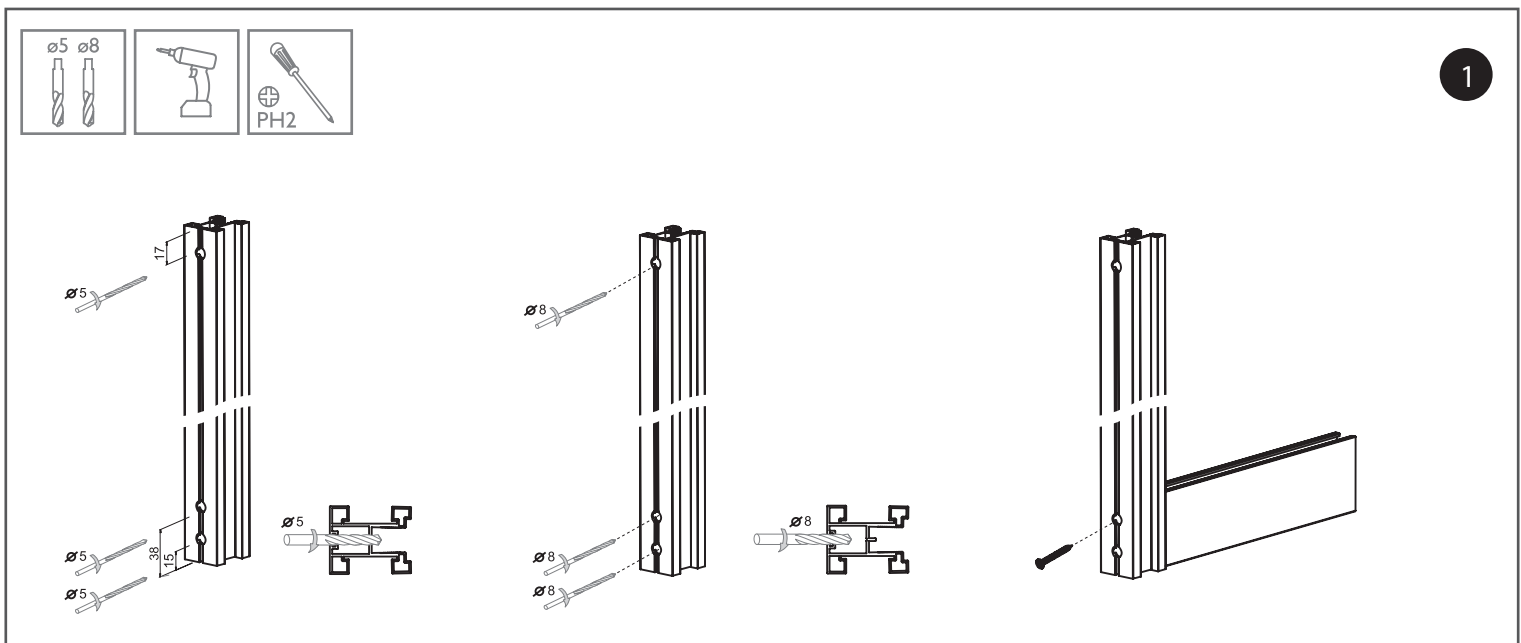

BS-Komfort mit Rahmentyp A

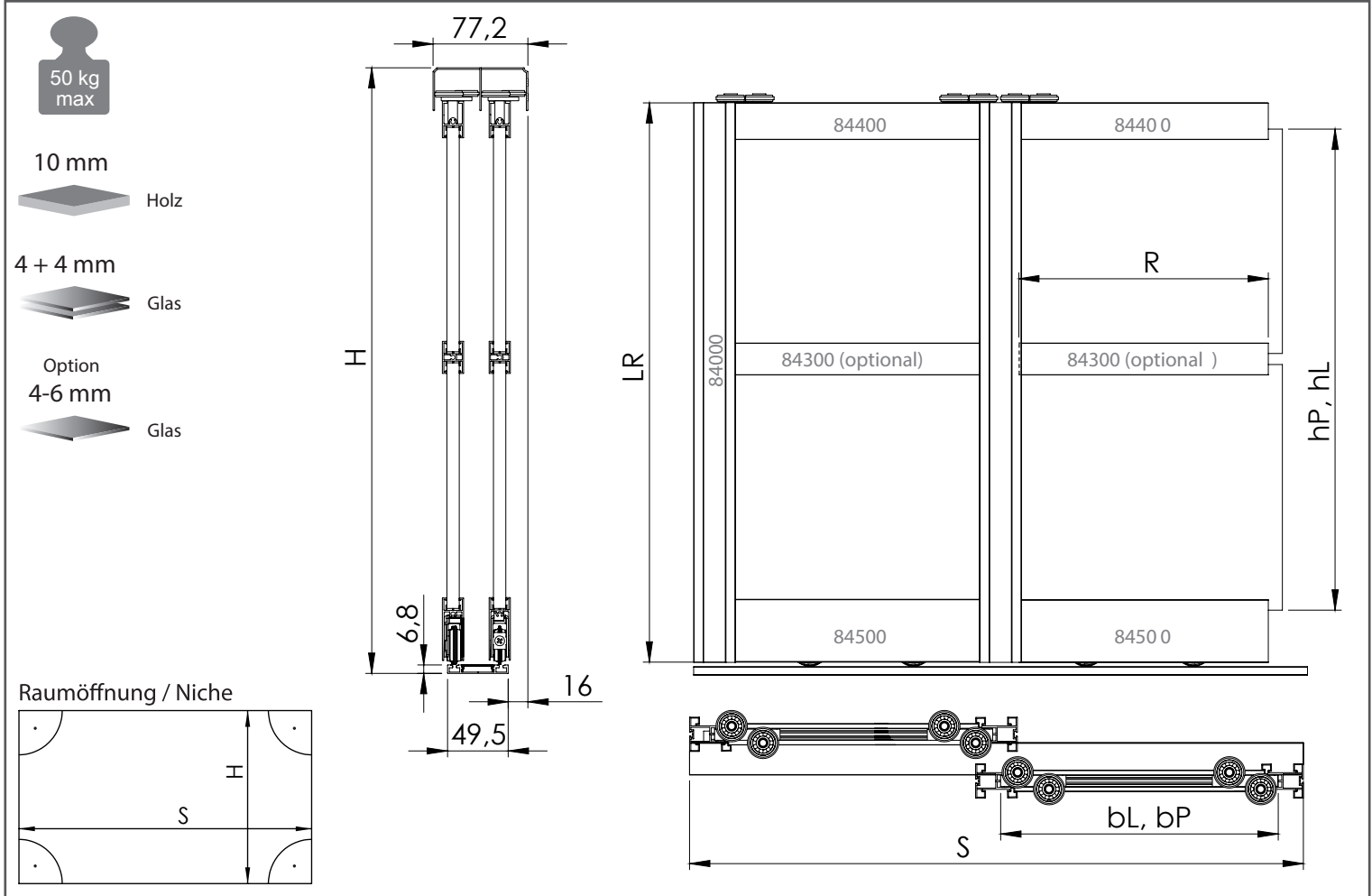

	Anzahl der Türen n / Quantity of doors n	n = 2	n = 3	n = 4	n = 5	n = 6	n = 7	n = 8
 10 mm	Füllungshöhe hP [mm]/ Board height hP [mm]	hP = H-104						
	Füllungsbreite bP [mm]/ Board width bP [mm]	$bP=(S-48)/2$	$bP=(S-55)/3$	$bP=(S-62)/4$	$bP=(S-70)/5$	$bP=(S-77)/6$	$bP=(S-84)/7$	$bP=(S-91)/8$
	Oberes, mittleres und unteres Querprofil R [mm]/ Upper, lower rail and connector lenght R [mm]	R = bP-23						
	Länge Griffprofil LR [mm]/ Handle lenght LR [mm]	LR = H-40						
 10 mm + 4/6 mm	Glashöhe hL [mm]/ Mirror height hL [mm]	hL = H-107						
	Glasbreite bL [mm]/ Mirror width bL [mm]	$bL=(S-54)/2$	$bL=(S-64)/3$	$bL=(S-74)/4$	$bL=(S-85)/5$	$bL=(S-95)/6$	$bL=(S-105)/7$	$bL=(S-115)/8$
	Oberes, mittleres und unteres Querprofil R [mm]/ Upper, lower rail and connector lenght R [mm]	R = bL-20						
	Länge Griffprofil LR [mm]/ Handle lenght LR [mm]	LR = H-40						
 4 + 4 mm lub 4 mm	Glashöhe hL [mm]/ Mirror height hL [mm]	hL = H-101						
	Glasbreite bL [mm]/ Mirror width bL [mm]	$bL=(S-36)/2$	$bL=(S-37)/3$	$bL=(S-38)/4$	$bL=(S-40)/5$	$bL=(S-41)/6$	$bL=(S-42)/7$	$bL=(S-43)/8$
	Oberes, mittleres und unteres Querprofil R [mm]/ Upper, lower rail and connector lenght R [mm]	R = bL-29						
	Länge Griffprofil LR [mm]/ Handle lenght LR [mm]	LR = H-40						

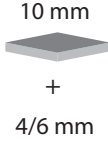
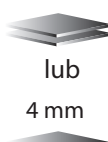

2.1

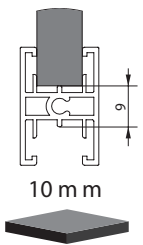

10 mm

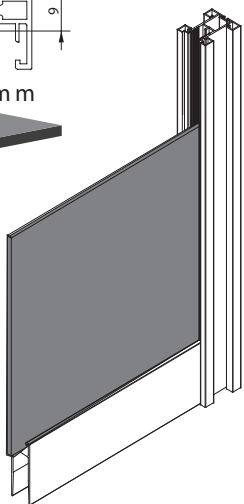

2.2

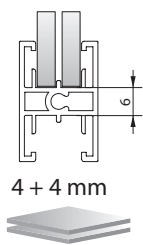

4 + 4 mm

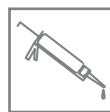
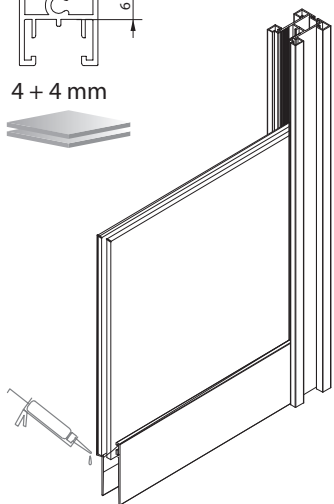

2.3

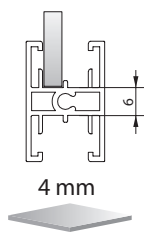

4 mm

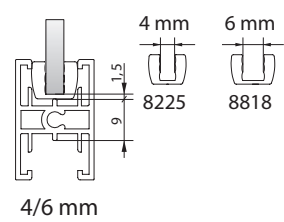
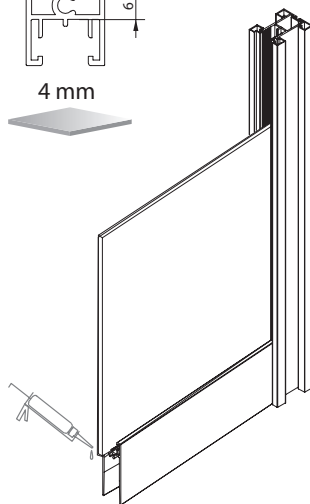

4/6 mm

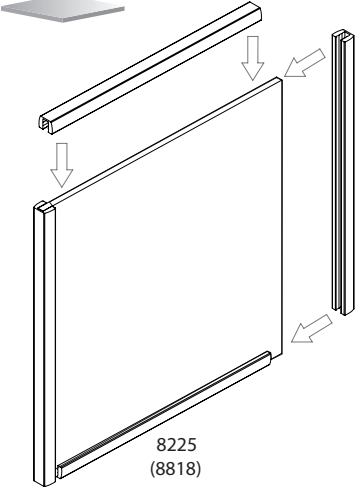

2.4



3

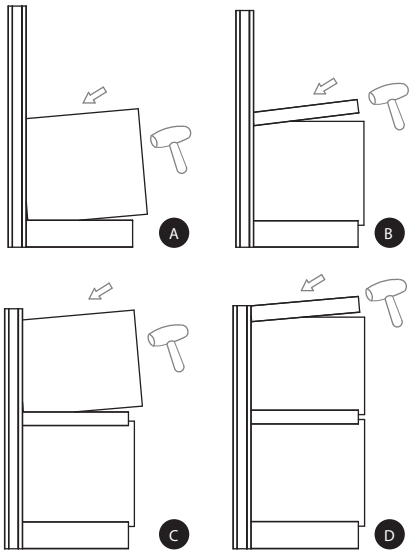

4

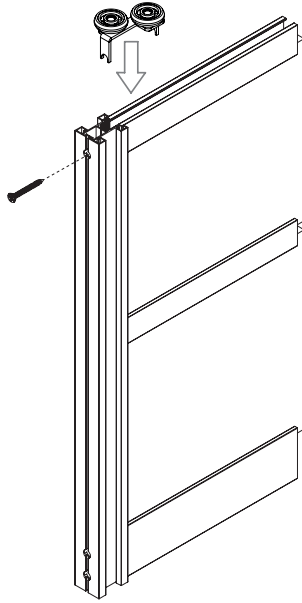

5

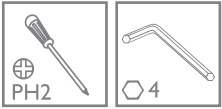
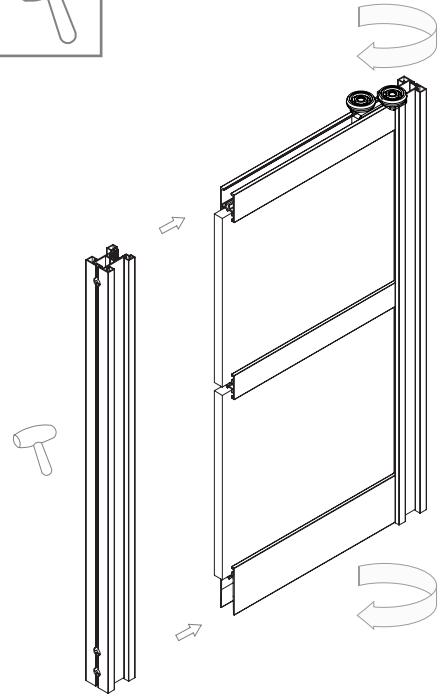

6

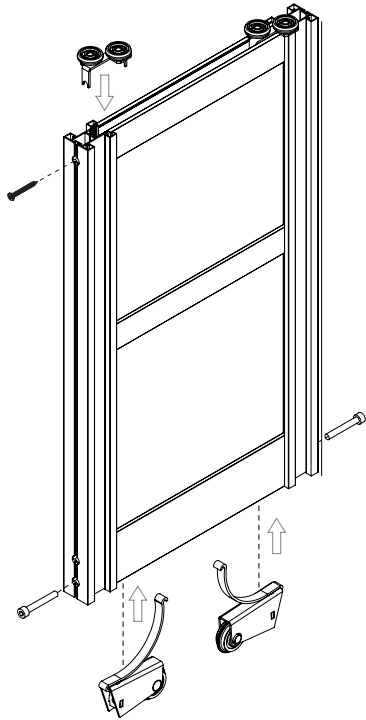

7

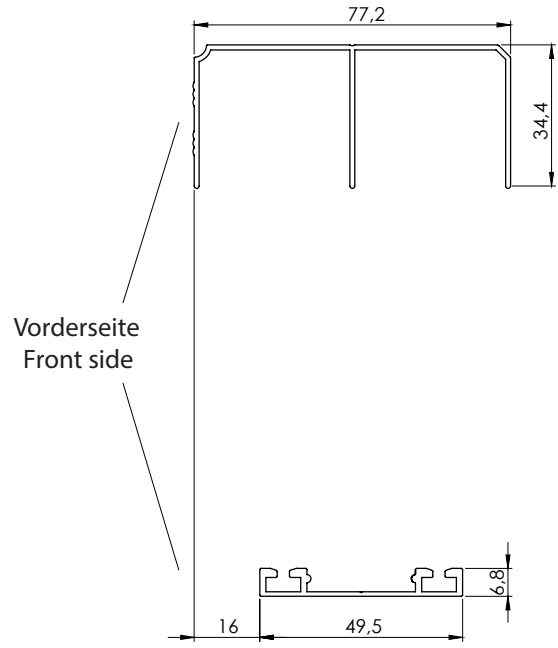

8.1

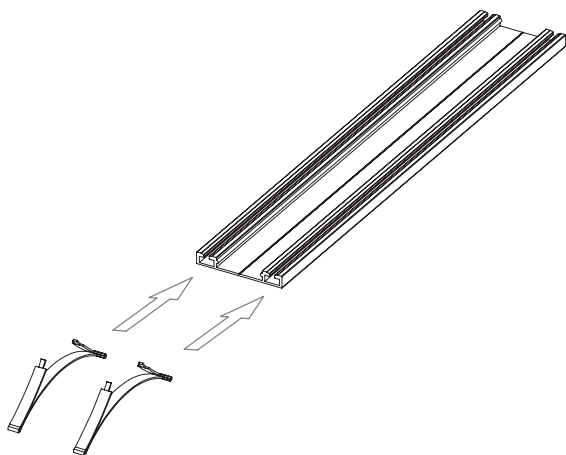

8.2

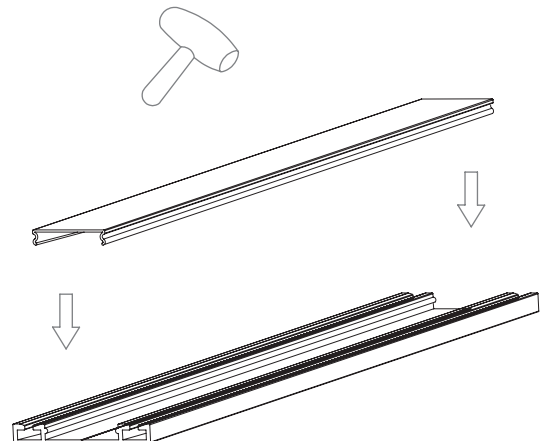

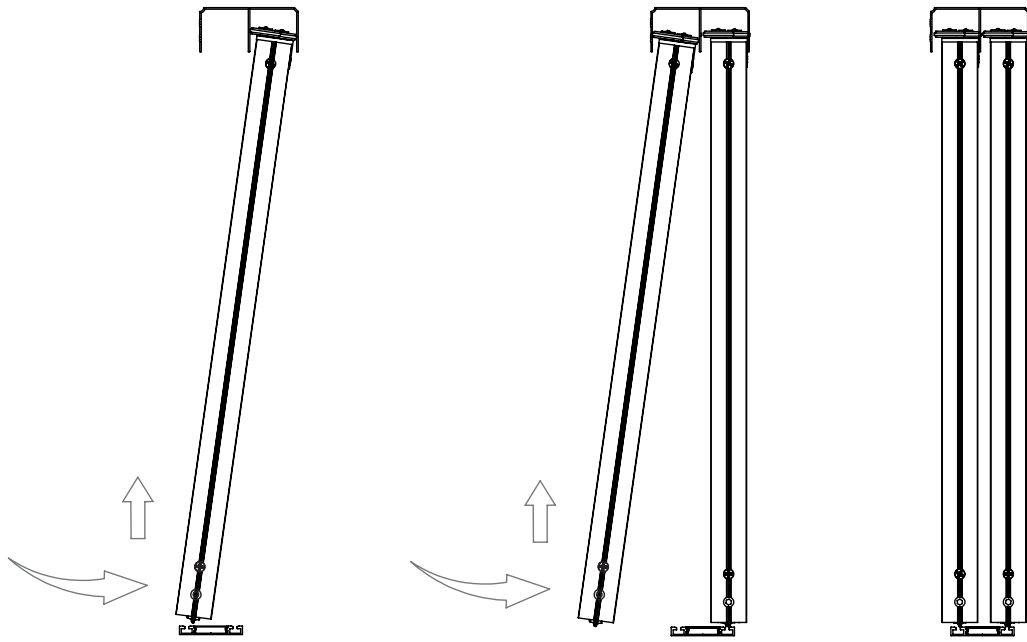

Bohrschablone
Drilling jigs

